

## Glazing Dimensions

L = Glass Length  
 H = Doorway Height  
 W = Doorway Width  
 Rail Length = Glass Width

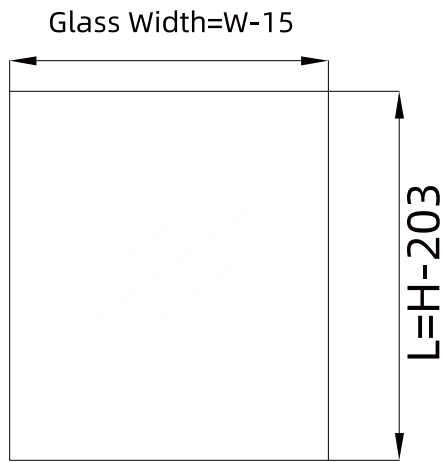

**1** For Single Door

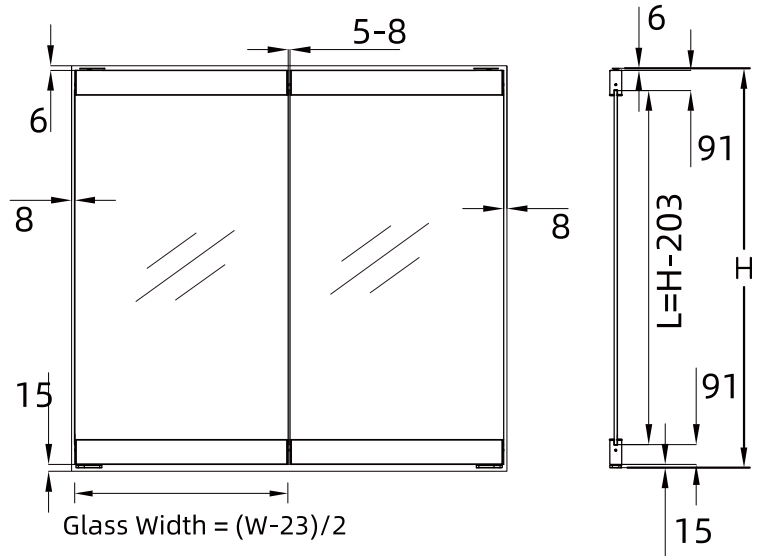
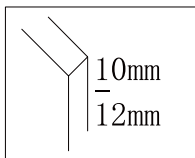

**2** For Double Door

## Top Positioning

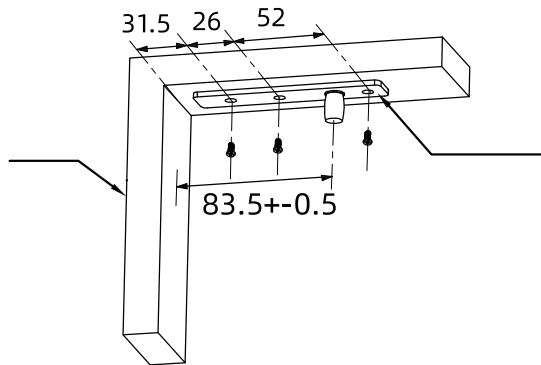

**3**

## Ground Drilling

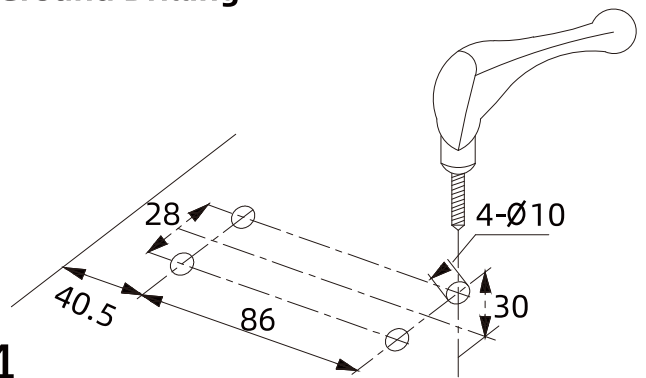

**4**

## Mounted Screws (Base plate)

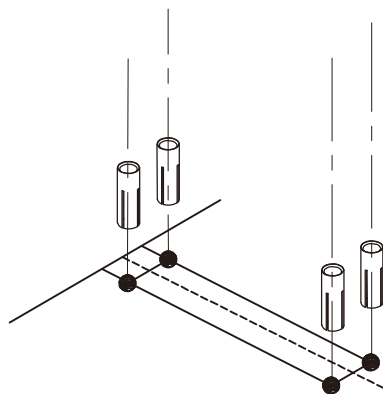

**5**

## Mounted Base Plate

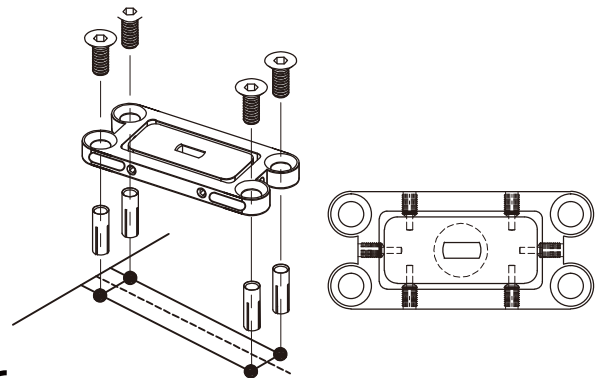

**6**

**Top Rail**

7

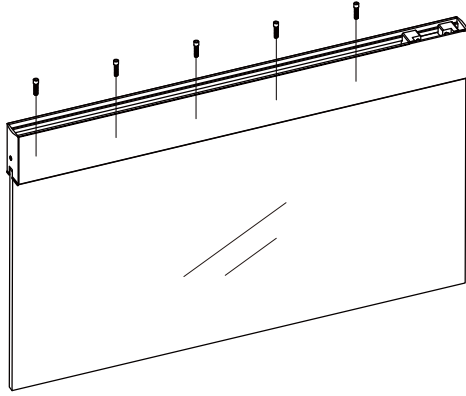

**Bottom Rail**

The edge of the hydraulic pump should be aligned with the edge of the door rail.

8

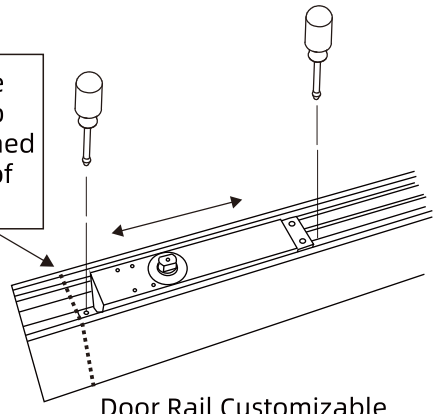

Door Rail Customizable

**Bottom Rail**

9

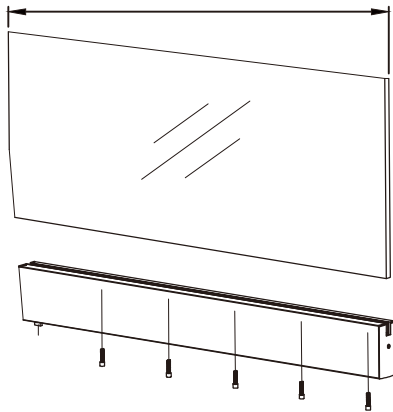

10

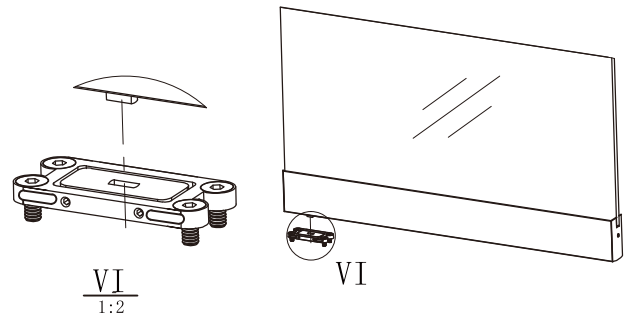

11

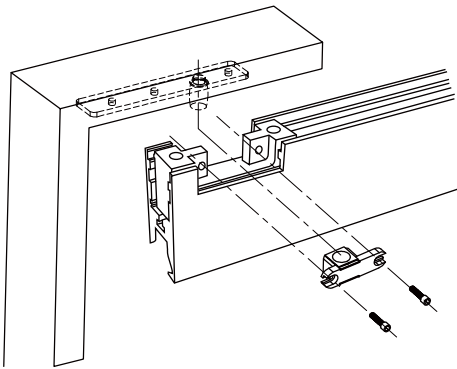

12

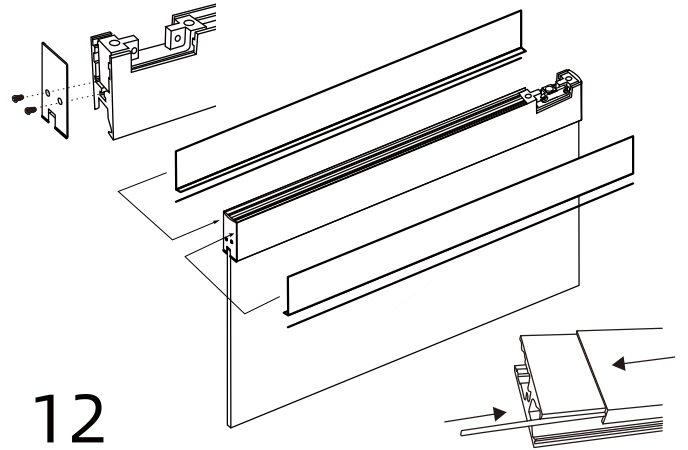

13

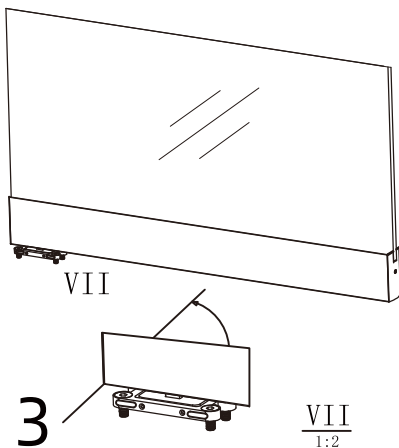

**Hydraulic Adjustment**

14

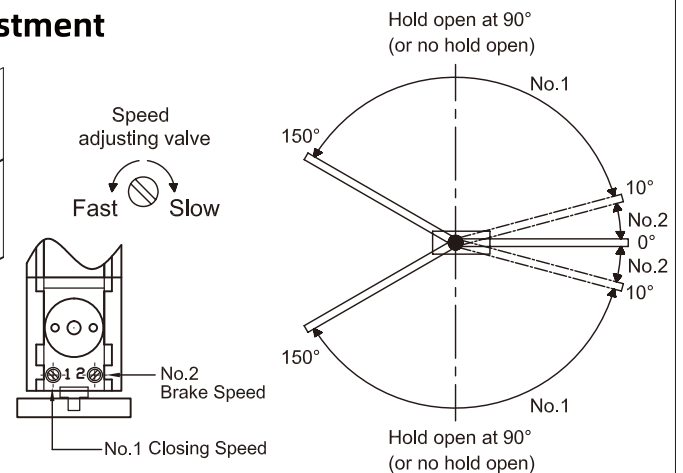
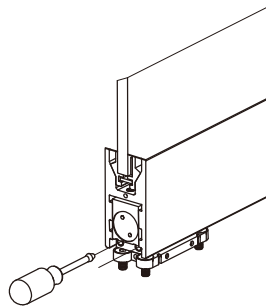

15

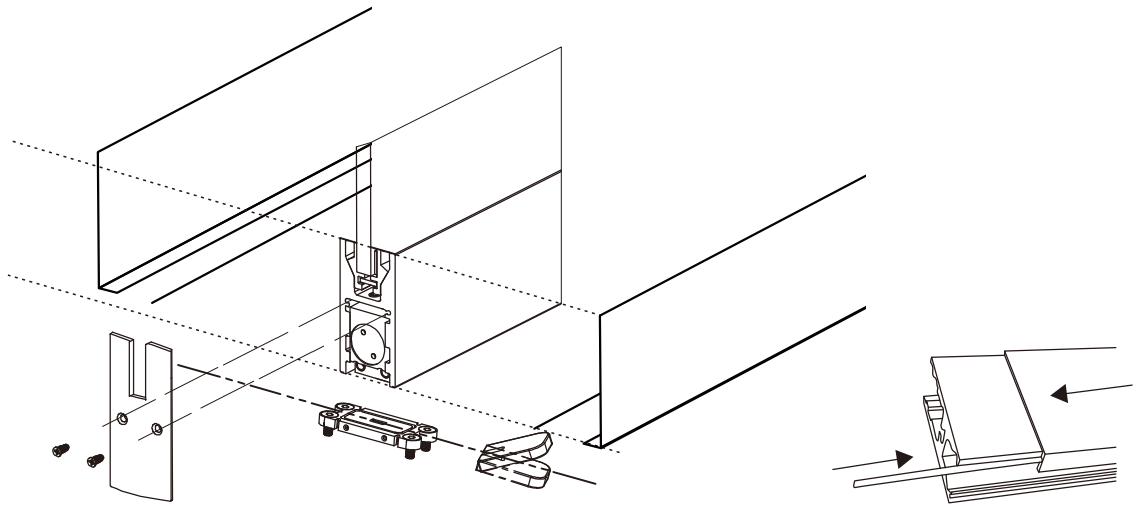

**Door Adjustment**



One Door  
Max 100kg

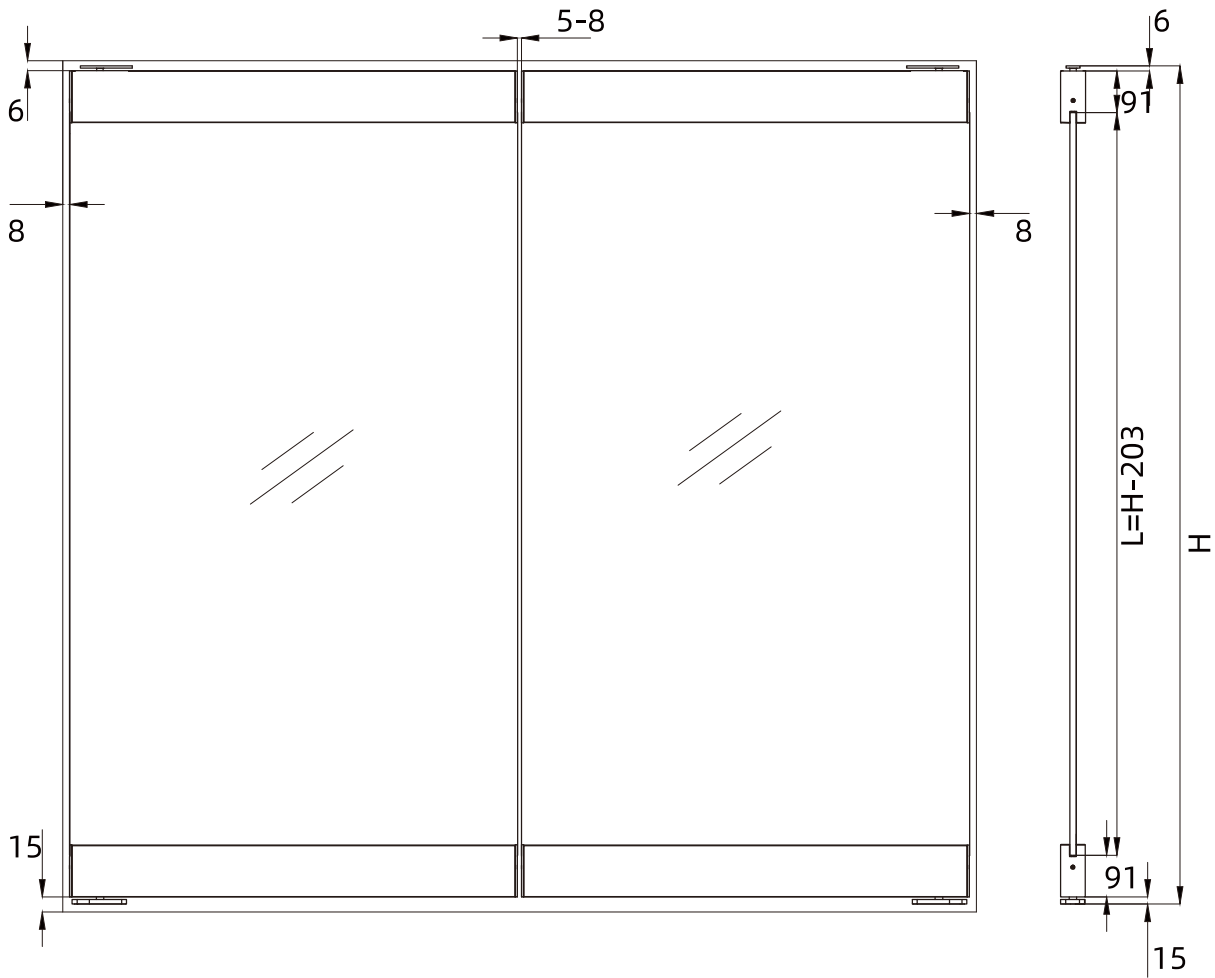

16